



Badminton Road
Bristol BS36 2QE

Price:
£1,600 PCM

Property Features

- Detached Bungalow
- 2 Bedrooms
- Ensuite & Bathroom
- Recently Refurbished
- Living Room
- Dining Room
- New Kitchen
- Unfurnished
- Pets Considered
- MUST BE VIEWED



GROUND FLOOR

Full Description

Entrance Hall

Living Room
15'8" x 12'6"

Dining Room
14'11" x 10'5"

Kitchen
9'2" x 8'8"

Conservatory
18'2" x 8'7"

Bedroom 1
15'2" x 13'0"

En suite Shower Room

Bedroom 2
11'10" x 18'2"

Bathroom

Front Garden

Off Street Parking

Rear Garden

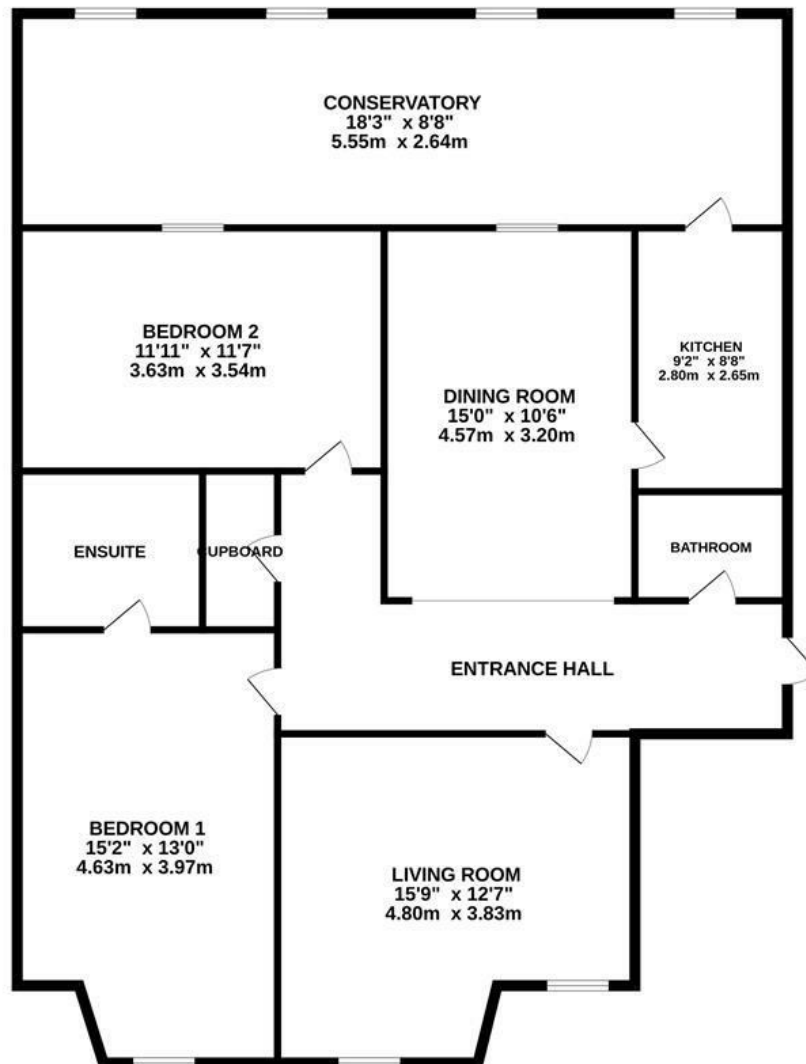

Measurements are approximate. Not to scale. Illustrative purposes only.
Made with Metropix ©2026

4 Flaxpits Lane
Winterbourne
Bristol
BS36 1JX

www.aj-homes.co.uk
info@aj-homes.co.uk
01454 252140

Agents Note: Whilst every care has been taken to prepare these sales particulars, they are for guidance purposes only. All measurements are approximate are for general guidance purposes only and whilst every care has been taken to ensure their accuracy, they should not be relied upon and potential buyers are advised to recheck the measurements